



FITTING INSTRUCTIONS FOR LP0379 LICENCE PLATE BRACKET



**This kit contains the items pictured and labelled over page.
Some parts may be shown for clarity of instructions only.
Do not proceed until you are sure all parts are present.
Please read all instructions before proceeding.**

**IF IN ANY DOUBT WHEN FITTING OUR PRODUCTS, CONSULT ONE OF OUR DEALERS
OR HAVE FITTED BY A QUALIFIED TECHNICIAN.**

Please note that the way the kit is packed does not necessarily represent the way of mounting to the bike.

In the event of rubber washers being used to hold components onto bolts, these rubber washers can be thrown away.

DIGITAL COPIES OF THESE INSTRUCTIONS ARE AVAILABLE FROM

WWW.RG-RACING.COM

R&G

Unit 1, Shelley's Lane, East Worldham, Alton, Hampshire, GU34 3AQ
Tel: +44 (0)1420 89007 Fax: +44 (0)1420 87301 www.rg-racing.com Email: info@rg-racing.com



<u>TOOLS REQUIRED</u>	<u>GENERAL TORQUE SETTINGS</u>
<ul style="list-style-type: none"> • Set of metric Hex keys • T25 & T30 Torx head tool • Set of metric sockets and wrench. <ul style="list-style-type: none"> • 8mm & 10mm spanners. <ul style="list-style-type: none"> • Cable cutters 	<p>M4 BOLT = 8Nm</p> <p>M5 BOLT = 12Nm</p> <p>M6 BOLT = 15Nm</p> <p>M8 BOLT = 20Nm</p> <p>M10 BOLT = 40Nm</p> <p>M12 BOLT = 40Nm</p>

LEGEND

ITEM No.	DESCRIPTION	QTY
ITEM 1	TB0379 - TAIL TIDY BRACKET	1
ITEM 2	TB0299 PART 2 - LICENCE PLATE MOUNT PLATE	1
ITEM 3	LA0002 - NUMBER PLATE LIGHT	1
ITEM 4	M6 x 1.00 x 20mm LONG BUTTON HEAD BOLT	3
ITEM 5	M6 x 12mm O/D WASHER	6
ITEM 6	M6 NYLOC NUTS	3
ITEM 7	M5 x 0.8 x 12mm COUNTERSUNK BOLTS	4
ITEM 8	M5 x 10mm O/D WASHERS	4
ITEM 9	M5 NYLOC NUTS	4
ITEM 10	CON0014 LICENCE PLATE CONNECTOR	1
ITEM 11	RB0002 RUBBER BUNG	1
ITEM 12	200mm LENGTH OF HEAT SHRINK	1
ITEM 13	CT100 100mm CABLE TIE	4
ITEM 14	CLIP 1 SELF ADHESIVE CABLE CLIPS	4
ITEM 15	REFL 3 REFLECTOR	1

R&G

Unit 1, Shelley's Lane, East Worldham, Alton, Hampshire, GU34 3AQ

Tel: +44 (0)1420 89007 Fax: +44 (0)1420 87301 www.rg-racing.com Email: info@rg-racing.com



ASSEMBLY DIAGRAM 1

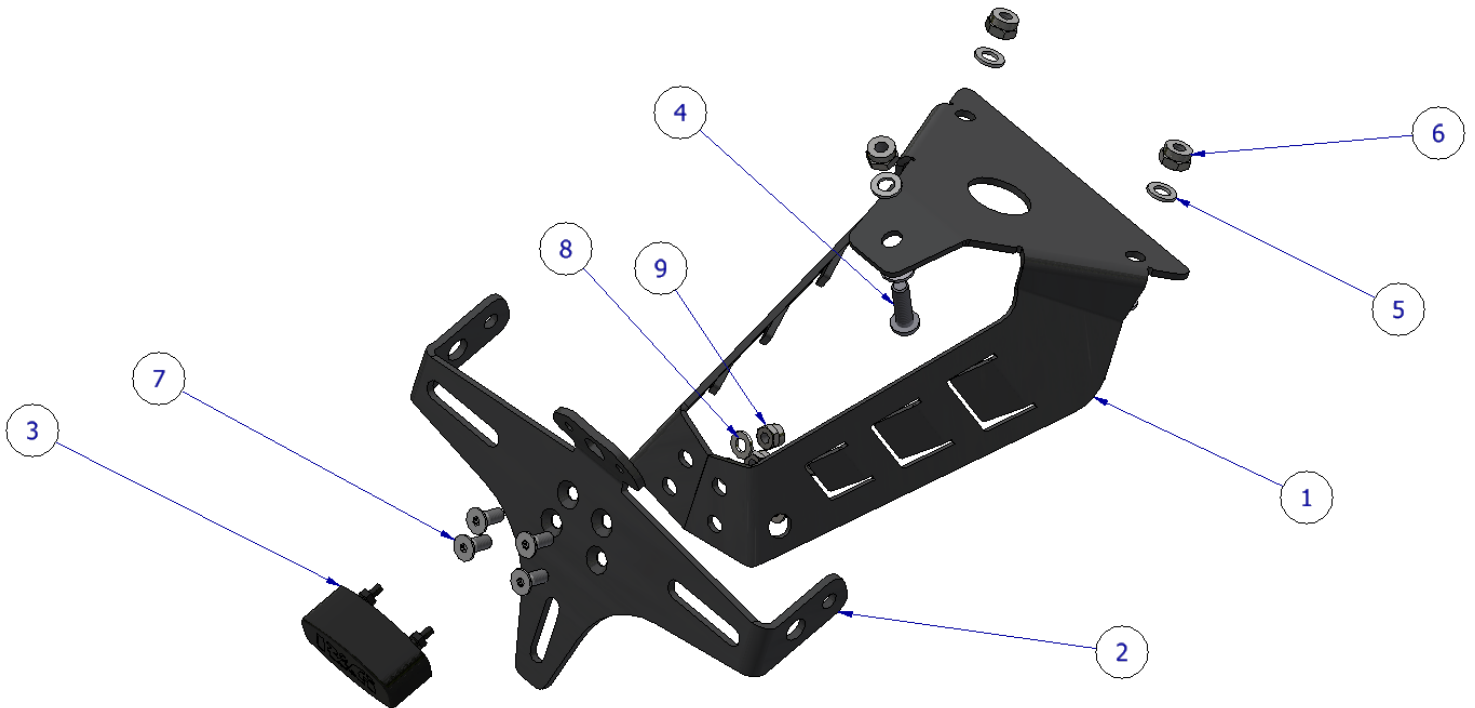

Assembly Diagram 2 – ANCILLARY COMPONENTS

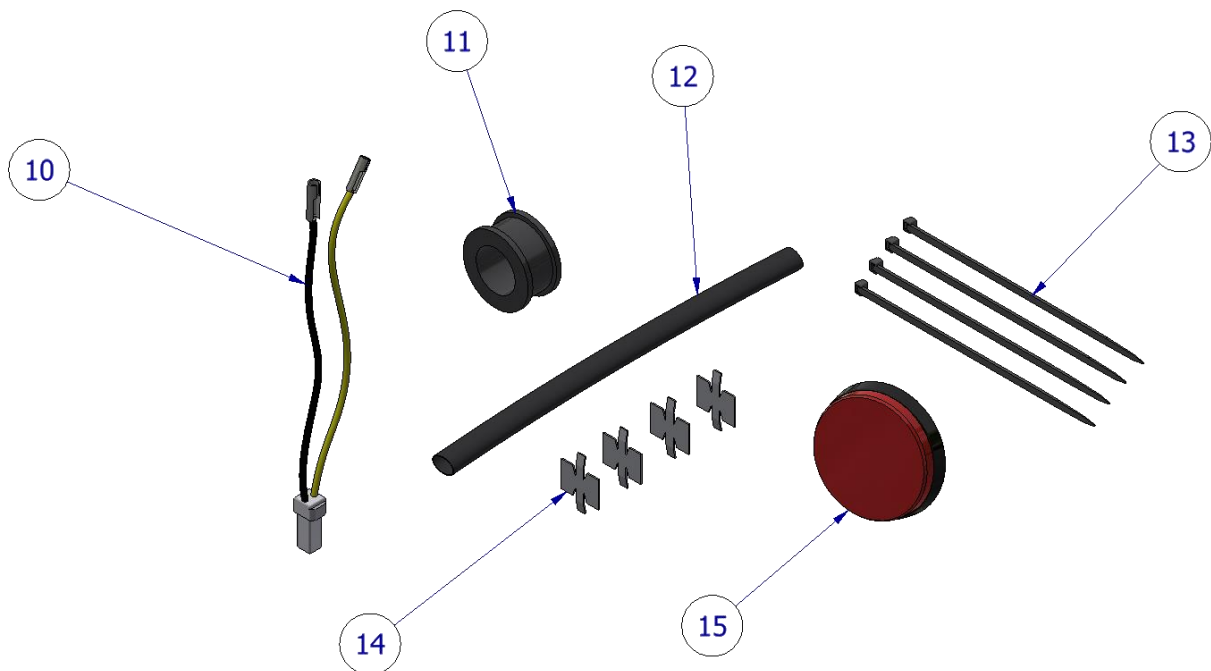

R&G



FITTING PICTURES

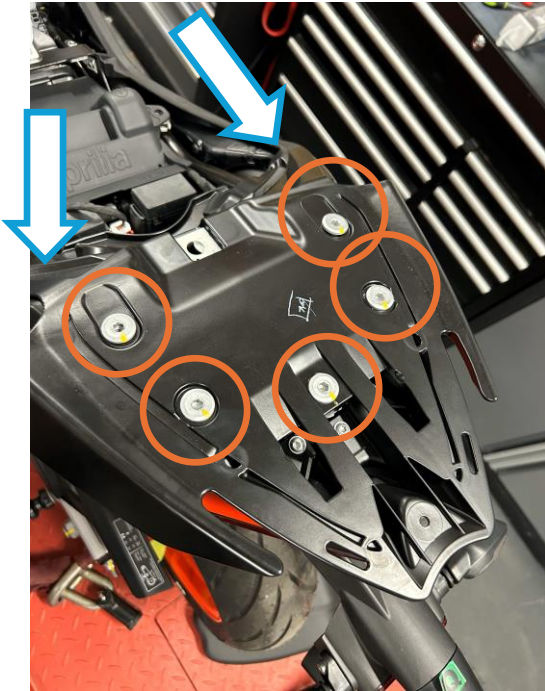

Picture 1

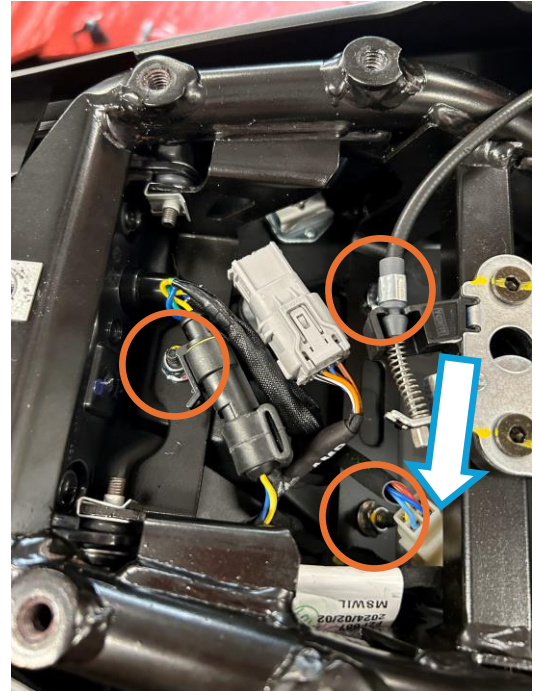

Picture 2



Picture 3



Picture 4



Picture 5

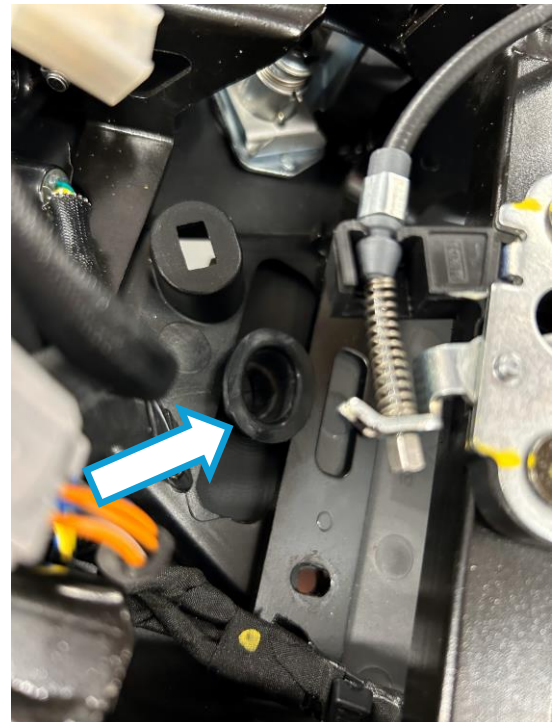

Picture 6

FITTING INSTRUCTIONS

- To fit the R&G tail tidy, remove both seats from the bike using the key.
- Remove the rear luggage rack plate by removing the 7x bolts shown in **picture 1**.
- Disconnect the tail unit wiring connection arrowed in **picture 2**.
- To remove the tail unit, use a 10mm socket or spanner to hold the 3 nuts circled in **picture 2**, while using a T30 torx to remove the 3x bolts from the underside of the tail unit in the locations circled in **picture 3**, being careful to thread the wiring through the slot in the bike as the unit is removed.
- The OEM tail unit will need to be partially disassembled to re-use the wiring sub-loom for indicators and licence plate light. To do this, remove the 4x screws circled in **picture 4** and remove the plastic panel.
- Remove the wiring sub loom by disconnecting the indicator and licence plate light connections and removing the sub-loom from the securing clip, arrowed in **picture 5**.
- To assemble the R&G tail tidy, refer to the Assembly Diagram 1 and follow the steps below:
 - Affix the TB0299 Part 2 plate mount bracket (**item 2**) using 4 x M5x12mm bolts (**item 7**), 4 x M5x12mm washers (**item 8**) and remaining M5 Nyloc Nuts (**item 9**).
 - Insert the rubber bung RB0002 Rubber bung (**item 11**) into the large hole in the mounting face of the tail tidy.
 - Place one section of heat shrink (**item 12**) over the wires of LA0002 (**item 3**) and heat carefully until wires are covered neatly.
 - Affix the LA0002 shroud if not already and secure with a small drop of superglue, this will direct the light towards the licence plate when fitted.
 - Fix the LA0002 (**item 3**) to the licence plate mount bracket using the 2 x nuts and washers provided using a 6mm socket as shown on **Assembly diagram 1**.
 - Attach the CON0014 (**item 10**) to the bullet connectors, ensuring to connect both **BLACK** wires together.

R&G

Unit 1, Shelley's Lane, East Worldham, Alton, Hampshire, GU34 3AQ

Tel: +44 (0)1420 89007 Fax: +44 (0)1420 87301 www.rg-racing.com Email: info@rg-racing.com



- Remove the OEM indicators from the OEM tail unit by removing the securing nut from each indicator and thread the wire through the bracket to remove.
- Ensuring fix the indicators to the correct side, thread the connector and wire through the indicator mount on the licence plate mount bracket and the wire hole on TB0379 (**item 1**). And affix the indicators securely with the with the OEM nut.
- With the light and indicators fixed to the tail tidy the OEM sub-loom removed earlier can be attached by connecting the relevant connectors to their counterparts.
- Secure the wiring and connectors by using the cable ties (**item 13**) to keep the wires together.
- Push the opposite end of the loom through the rubber bung in the main bracket (**item 1**) and pull through the extra wire.
- Use the self-adhesive cable clips (**item 14**) to tidy any loose wires.
- The tail tidy is now fully assembled and can be affixed to the bike, offer the tail tidy up to the bike. Ensure to push the protruding section of the rubber bung (**item 11**) through the slot, as shown in **Picture 6**.
- From below, pass the M6x20mm bolts (**item 4**) through the main bracket (**item 1**), M6 washers (**item 5**) and undertray, so the end of the bolt is accessible from the inside of the bike.
- Secure these bolts in place by using another M6 washer (**item 5**) and an M6 Nyloc nut (**item 6**) for each bolt.
- Adjust the tail tidy on the slots if necessary, to ensure all components line up correctly
- Now fully tighten each bolt to the correct torque so the tail tidy is fully secured to the bike.
- Reconnect the OEM sub-loom to the OEM connector removed previously.
- Test both indicators and the licence plate light function correctly. If lights fail to illuminate, then swap the bullet connectors around and re-test.
- Re-fit the bodywork as previously fitted by reversing the steps above.
- Re-fit the licence plate (it may require drilling).
- Depending on local laws, attach enclosed reflector (**item 15**) in an appropriate location.
- Test the licence plate illuminator and all lights before riding.
- **IMPORTANT: IF FITTING A FULL-SIZE LICENCE PLATE AND PLACING IT FAR DOWN ON THE LICENCE PLATE HANGER, THERE IS A SMALL CHANCE OF THE LICENCE PLATE HITTING THE BACK WHEEL UNDER HEAVY LOAD AND OVER LARGE BUMPS IN THE ROAD. IT IS YOUR RESPONSIBILITY TO CHECK FOR THIS POSSIBILITY AND TAKE AVOIDING ACTION. FAILURE TO CHECK THIS COULD RESULT IN SERIOUS INJURY.**

ISSUE 1 - 07/05/2024 (MH)

CONSUMER NOTICE

The catalogue description and any exhibition of samples are only broad indications of the Products and R&G may make design changes which do not diminish their performance or visual appeal and supplying them in such state shall conform to the order. The Buyer acknowledges no representation or warranty (other than as to title) has been given or will apply to the Products other than those in R&G's order or confirmation and the Buyer confirms it has chosen the Products as being of merchantable quality and suitable for its particular purposes. Where R&G fits the Products or undertakes other services it shall exercise reasonable skill and care and rectify any fault free of charge unless the workmanship has been disturbed. The Buyer is responsible for ensuring that the warranty on the motorcycle is not affected by the fitting of the Products. On return of any defective Products R&G shall at its option either supply a replacement or refund the purchase money but shall not be liable if the Products have been modified or used or maintained otherwise than in accordance with R&G's or manufacturer's instructions and good engineering practice or if the defect arises from accident or neglect. Other than identified above and subject to R&G not limiting its liability for causing death and personal injury, it shall not be liable for indirect or consequential loss and otherwise its liability shall be limited to the amounts paid by the Buyer for the Products or the fitting or service concerned. These terms do not affect the Buyer's statutory rights.

R&G RACING RETURNS POLICY (NON-FAULTY GOODS)

Returns must be pre-authorized (if not pre-authorized the return will be rejected). Goods may only be returned direct to us if they were purchased direct from us (customer must prove if necessary). Otherwise to be returned to original vendor. Goods must be in re-sellable condition, in the opinion of R&G Racing. All returns are subject to a 25% restocking and handling fee (25% of the gross value exc. P&P - at the prevailing price at time of purchase). The customer must pay any and all carriage charges. No returns of discontinued products, unless within 14 days of purchase. This policy does not affect your statutory rights and does not refer to faulty goods.

R&G

Unit 1, Shelley's Lane, East Worldham, Alton, Hampshire, GU34 3AQ

Tel: +44 (0)1420 89007 Fax: +44 (0)1420 87301 www.rg-racing.com Email: info@rg-racing.com