

Denali Light Mount

BMW G650GS '09-'14

BMW F650GS Single '00-'07

LAH.07.10600 Instructions Rev:00

PLEASE READ BEFORE INSTALLING

TWISTED THROTTLE products should be installed by a qualified, experienced motorcycle technician. If you are unsure of your ability to properly install a product, please have the product installed by your local motorcycle dealer. TWISTED THROTTLE takes no responsibility for damages caused by improper installation.

All screws, bolts, and nuts, including all replacement hardware provided by TWISTED THROTTLE should be tightened to the torque specified in the OEM maintenance manual for your motorcycle. If no torque specifications are provided in the OEM maintenance manual, the following torques may be used:

M5.....	3.5 ft-lbs (5 Nm)
M6.....	7 ft-lbs (9.6 Nm)
M8.....	13 ft-lbs (18 Nm)

All screws, bolts, and nuts should be checked after driving the first 30 miles (50 km) to ensure that all are tightened to the proper torque.

Medium strength liquid thread-locker (i.e., "Loctite") should be used to secure all screws, bolts, and nuts.

Distributed by:	
Twisted Throttle LLC 570 Moose Neck Rd Exeter, RI 02822	phone: 855.255.5550 fax: 401.223.6955 www.twistedthrottle.com



Step 1

1 Bracket
LAH.07.010
Qty.....1



2 Hex Head Screw
M6x45.....DIN 931
Qty.....2



3 Hex Head Screw
M6x35.....DIN 931
Qty.....2



4 Washer
M6.....DIN 125
Qty.....4



5 Spcaer
OD: 19mm ID:6.5mm L: 25.4mm
Qty.....2



6 Spacer
OD: 19mm ID:6.5mm L: 15.9mm
Qty.....2

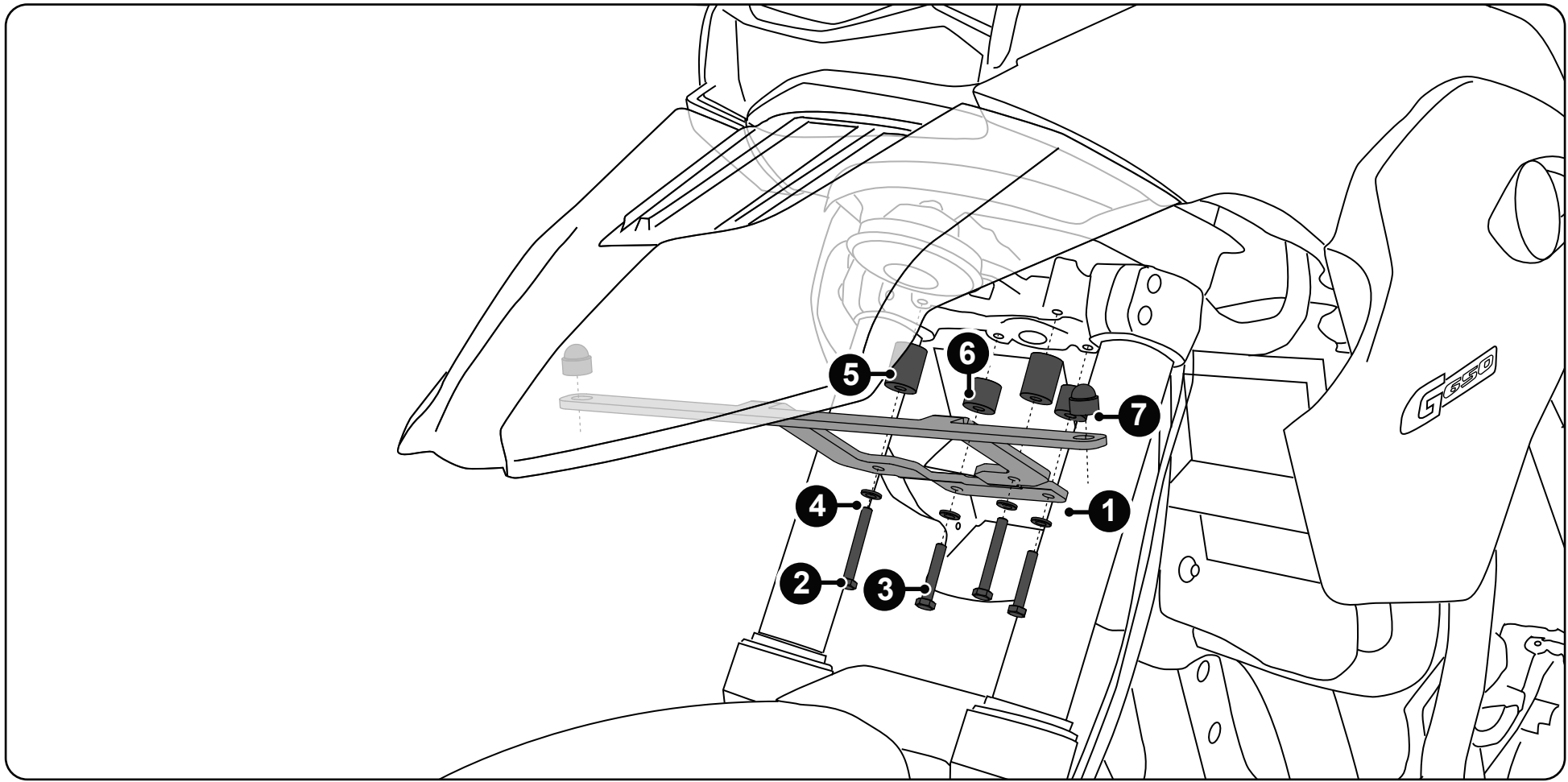

7 Nut Cap
M8
Qty.....2

Step One: Remove the four bolts on the underside of the upper front fender. Use the supplied hardware to mount the light bracket to the motorcycle, the longer bolts (#2) and spacers (#5) mount into the holes towards the front end of the motorcycle. Use the supplied Nut Caps (#7) to cover the nut used to mount the light pods to the bracket.