

# DENALI™

LAH.01.10400

## AUXILIARY LIGHT MOUNT

HONDA  
CB500X  
2013 -

### Thank you for choosing DENALI

We know you would rather be riding your bike than wrenching on it, so we go the extra mile to make sure our instructions are clear and as easy to understand as possible. If you have any questions, comments, or suggestions don't hesitate to give our gear experts a call at 401.360.2550 or visit DenaliElectronics.com

### Please Read Before Installing

DENALI products should always be installed by a qualified motorcycle technician. If you are unsure of your ability to properly install a product, please have the product installed by your local motorcycle dealer. DENALI takes no responsibility for damages caused by improper installation. **Caution:** When installing electronics it is extremely important to pay close attention to how wires are routed, especially when mounting products to the front fender, front forks, or fairing of your motorcycle. Always be sure to turn the handlebars fully left, fully right, and fully compress the suspension to ensure the wires will not bind and have enough slack for your motorcycle to operate properly.

### Installation Tips

We strongly recommend using medium strength liquid thread locker on all screws, nuts, and bolts. It is also important to ensure that all hardware is tightened to the proper torque specifications as listed in your owner's manual. For included accessory hardware please refer to the default torque specifications provided below. Inspect all hardware after the first 30 miles to ensure proper torque specifications are maintained.

Bolt Size	in-lbs	ft-lbs	Nm
M3	10.0 in-lbs	-	1.0 Nm
M4	23.0 in-lbs	-	2.5 Nm
M5	44.5 in-lbs	3.5 ft-lbs	5.0 Nm
M6	78.0 in-lbs	6.5 ft-lbs	9.0 Nm
M8	-	13.5 ft-lbs	18.0 Nm
M10	-	30.0 ft-lbs	41.0 Nm
M12	-	52.0 ft-lbs	71.0 Nm

### Hardware Sizing Guide

Not sure what size bolt you have? Use this ruler to measure screws, bolts, spacers, etc. Remember, the length of a screw or bolt is measured from the start of the "mounting surface" to the end of the screw, so only include the screw head when measuring countersunk screws.

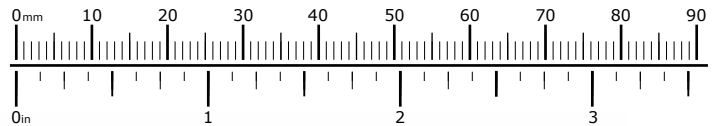

**FIGURE 1**

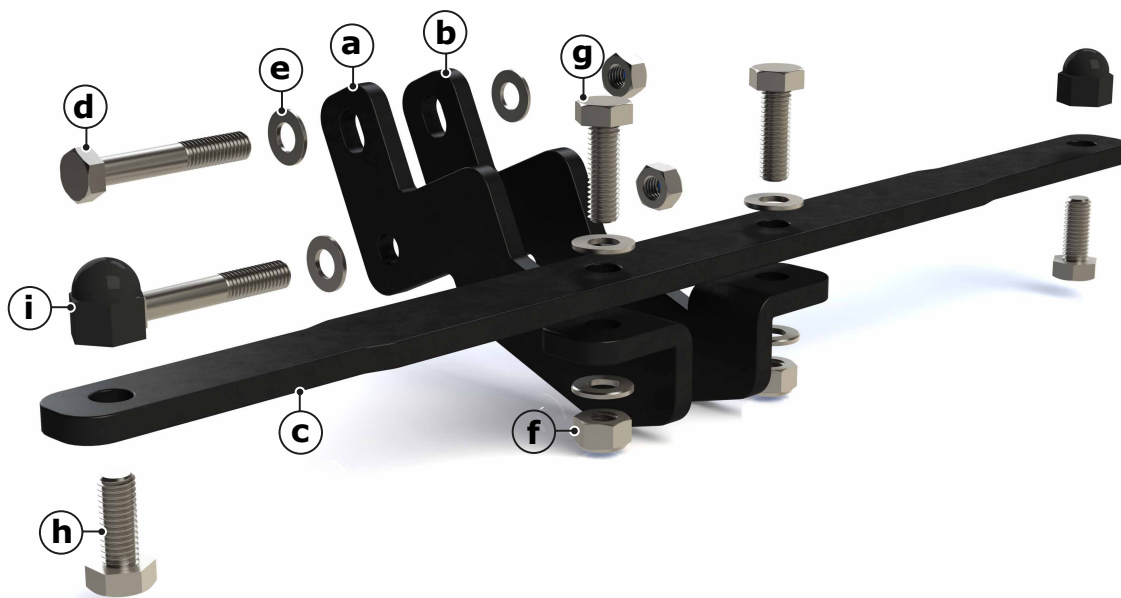

Illustration not to scale

### Kit Contents

(a) Right Side Bracket.....Qty 1	(h) M8x20 DIN 933.....Qty 2
(b) Left Side Bracket.....Qty 1	(i) M8 Plastic Nut Cap.....Qty 2
(c) Light Bar.....Qty 1	
(d) M8x50 DIN 931.....Qty 2	
(e) M8 Washer DIN 125.....Qty 8	
(f) M8 Nut DIN 985.....Qty 4	
(g) M8x25 DIN 933.....Qty 2	

### Tools Required

- 13mm Wrench (x2)
- 12mm Wrench (x2)

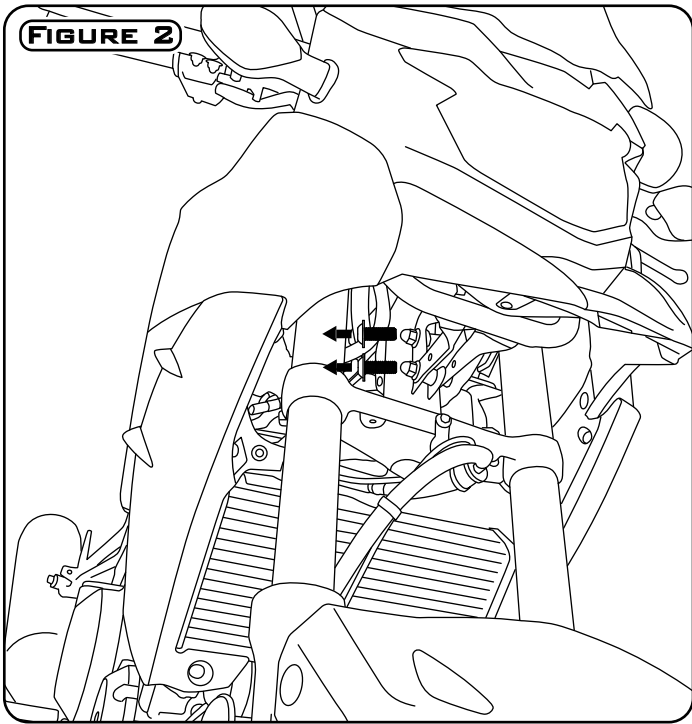

## Removing the OEM Bolts

**Step One:** Remove the OEM M8 bolts and nuts from the fairing stay.

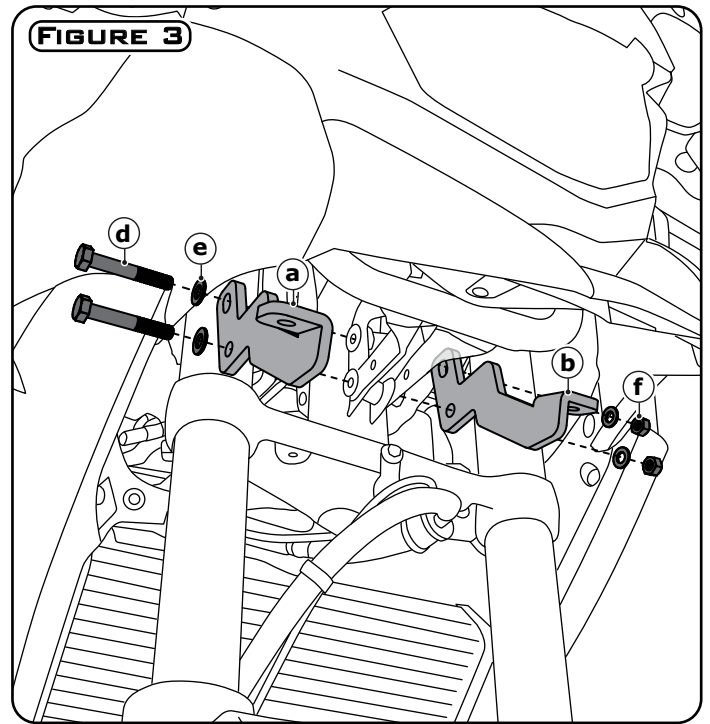

## Installing the Mounting Brackets

**Step Two:** Use the included M8x50 bolts (d), M8 washers (e) and M8 nuts (f) to secure the right (a) and left (b) mounting brackets to the fairing stay.

**Note:** Do NOT fully tighten the hardware at this time.

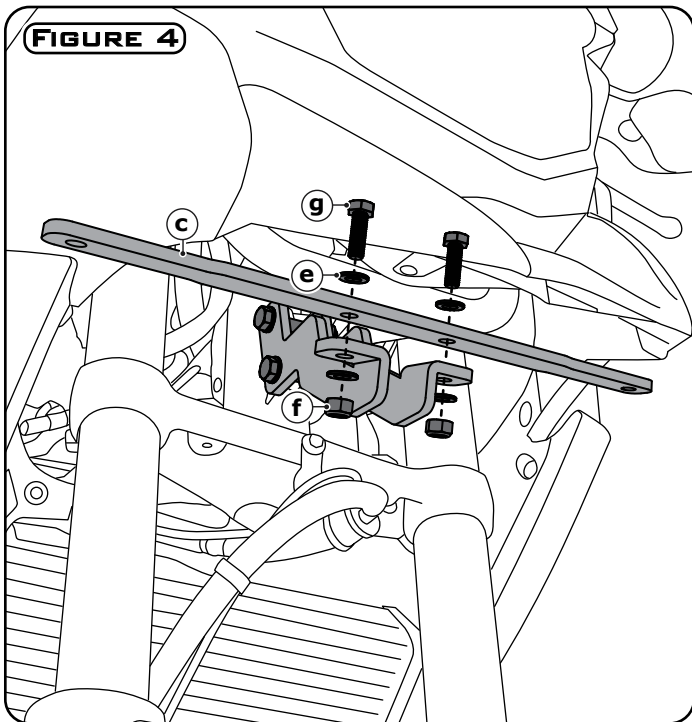

## Mounting the Light Bar

**Step Three:** Use the included M8x25 bolts (g), M8 washer (e) and M8 nuts to attached the light bar (c) to the right and left brackets and tighten fully.

**Step Four:** Next, go back and tighten the hardware installed in step two.

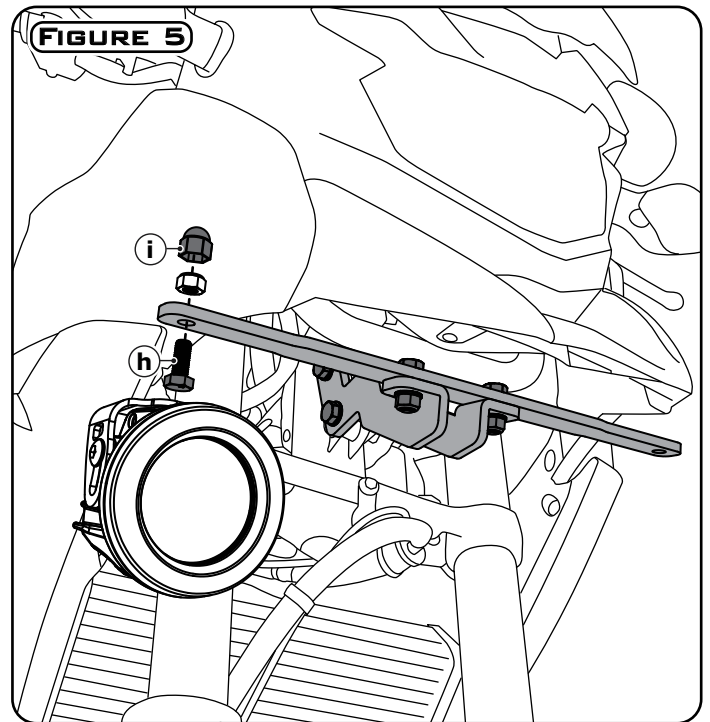

## Mounting the Lights

**Step Five:** Use the M8x20 bolts (h) and M8 nut caps (i) along with the hardware included with your light pod to attached the pods to the light bar.

**Caution:** Its extremely important to pay close attention to how you route the wires.

**Step Six:** Before operating the motorcycle, turn the handlebars fully left, fully right and fully compress the suspension. Confirm that the lights do not interfere with operation and

that the wires have enough slack to account for all suspension and steering movement.